



Isleham CE Primary School
School Council Welcome Pack

(Picture drawn by Harlee Y1)

Introduction (Written by Y6 class reps)

We, the members of the school council, would like to welcome you to Isleham CE Primary School. We think it is a great place to learn and make new friends. You will certainly feel cared for and safe here.

Lessons (Written by Y5 class reps)

Everyone in the school gets to link their lessons to their topic, for example Year 5 are doing the theme of 'Lights, Camera, Action' and have been learning how to make a video on the i-pads and finding out about light sources and shadows in science. In addition, we have special lessons for themed weeks like Anti-bullying week and Book week. Recently, Year 5 participated in a drama activity which resulted in a play for KS2 about keeping safe on the Internet.

Our teachers try to make our lessons fun and productive. For example KS1 and Foundation have been using a nearby wood to inspire their creative writing!

Assemblies (Written by Y4 class reps)

Every day we have an assembly in the morning, usually it is held in the hall first thing after registration. On Monday we got told the theme for the week and this tends to be linked to our SEAL topics. We also have a singing assembly where we get taught new songs and this is usually great fun. Each class has a time to lead assembly each term and they show what they have been learning, e.g. Year 4 just did an assembly on Dreams and Mountains! We are all encouraged to share a prayer in assembly and each day we sing a hymn, even if we have a small assembly in our classrooms.

Playtime and Lunchtime (Written by Y6 class reps)

We are really lucky here at Isleham, as we have a superb climbing frame and an outstanding climbing wall which we can use anytime. In addition, there is a pirate ship for those who enjoy creative play and sailing on the wild seas! A tree-area provides lots of shade and for those who like a little peace at playtime there is a quiet area where they can read or draw. For those who like more action-packed play, there is a fully-stocked play equipment shed with everything you need to have FUN!

If the weather is fine, then we are allowed to go onto the school field. There is a willow shelter and a bark area set up with benches to sit and rest on. We are also lucky enough to play on this field when it snows and see who can make the biggest snowperson!

School Dinners (Written by Y2 class reps)

Every one eats in the hall and we get really nice food. There are lots of different foods; we particularly like pizza which is sometimes served on a Thursday. Some people bring their own packed lunch in from home. We like the lunch to be healthy so encourage people to have a piece of fruit and some vegetables like carrots.

You can get a sticker for eating all your lunch and being polite. To help children in Reception, there are lunchtime buddies in Year 6 who help them with their dinner e.g. help with trays and undo wrappers. The buddies also take the younger children down to their classroom once lunch is over.

Clubs and Activities (Written by Y5 class reps)

There are always lots of different activities and clubs to join in and out of school time. For example on Friday lunchtimes there is a cross-country club, and a choir, on Tuesdays and Thursdays there is a chess club and also a science club. After school there are opportunities to learn more about film, gymnastics, cheerleading, gardening and football. We are really lucky to have lots of parent volunteers to help run these clubs.

Special Activities and School Trips (Written by Y3 class reps)

Every year, each class goes on at least one school trip. Some of our classes have been to Wimpole Farm, Hunstanton, Wicken Fen, The Fitzwilliam Museum, Ely Museum and Sutton Hoo. All our trips link to our topic work so new places are visited all the time.

In addition, the Year 5 and 6 children go on a residential every two years where they develop team working skills and get to try adventurous activities like canoeing, raft building and abseiling!

We celebrate Book Week with special events such as book fairs and dressing up as characters from our favourite books. Recently our theme was Fairy tales and we got to see the Norwich Puppet theatre perform 'Red Riding Hood' which was magical!

At Christmas we also have a special performance which could be a pantomime, a drama workshop, musical or magic show! Every-one gets to join in and it is lots of fun.

The information in this document, written by the school council, should answer all your questions about our school but we are a friendly place so do not hesitate to ask anyone of us!

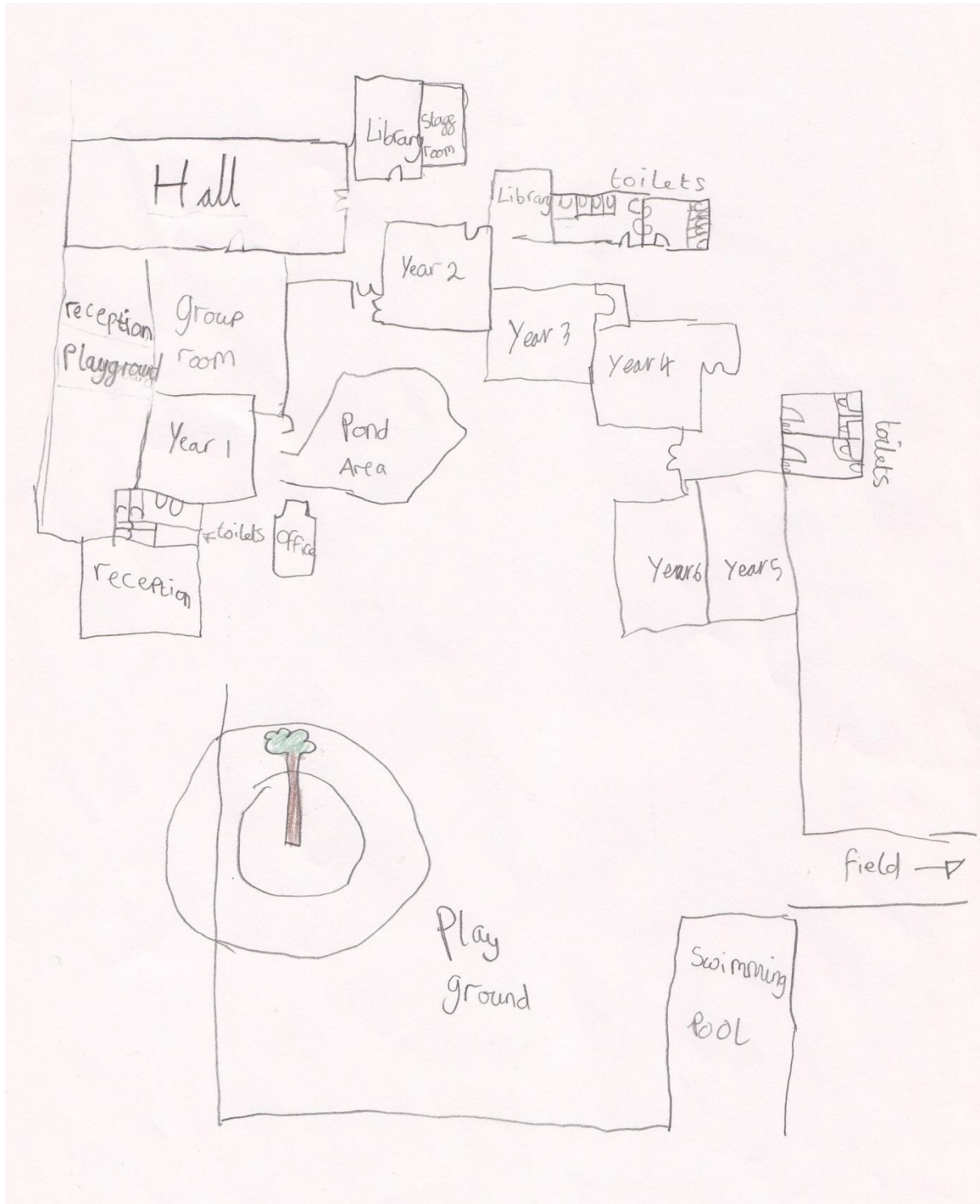

School map drawn by Maddie and Ben (Y5)

Isleham Primary School Poem

We've written you a little rap
to show you'll learn in just a snap
The teachers are so cool

We really do love school
You learn much more than the abc
Isleham primary is the place to be,

Isleham primary is the place to be
So much fun you won't believe
Let us tell you what's going on
Everyone here usually gets along
Happiness is what makes this school run
Assembly's so interesting
Make yourself comfortable by coming to Isleham Primary
school.

Welcome to Isleham Poem, written by Niamh and Connor (Y6)